

**PREMISES NO.- 608A/5, PURBACHAL MAIN ROAD IN WARD NO.- 106, BOROUGH - XII,
P.S.- GARFA, UNDER KOLKATA MUNICIPAL CORPORATION, DAG NO.- 2008, KHATIAN
NO.- 633, MOUZA - GARFA, UNDER K.M.C.**

CO-ORDINATE IN WGS84		
REFERENCE POINT MARKED IN SITE PLAN OF THE PROPOSAL	CO - ORDINATE	
	LATITUDE	LONGITUDE
(A)	22° 30' 10" NORTH	88° 23' 25" EAST
(B)	22° 30' 10" NORTH	88° 23' 25" EAST
(C)	22° 30' 10" NORTH	88° 23' 25" EAST
(D)	22° 30' 10" NORTH	88° 23' 26" EAST

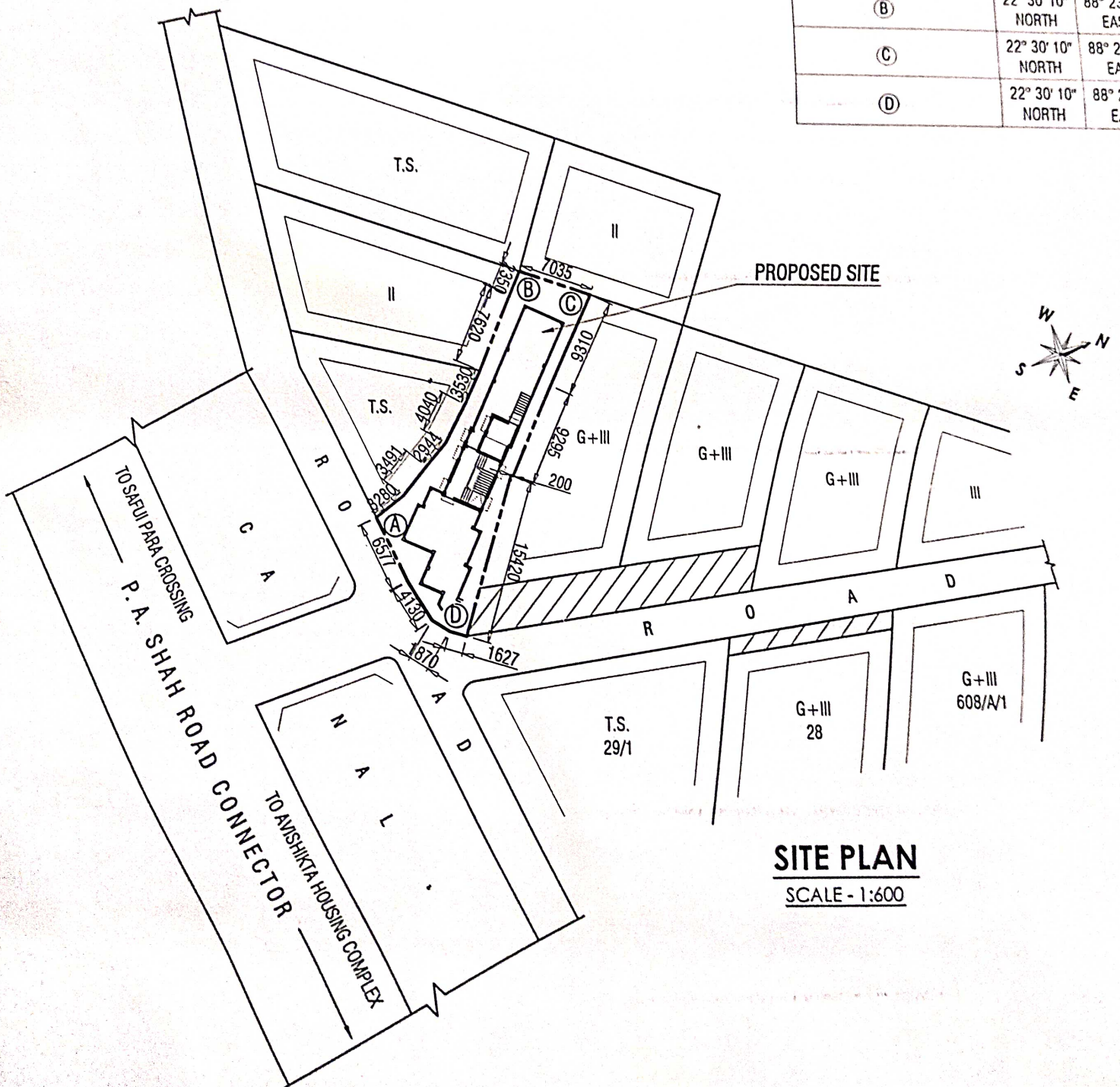

SITE PLAN
SCALE - 1:600